

Main Concourse – Concessions Stand Map

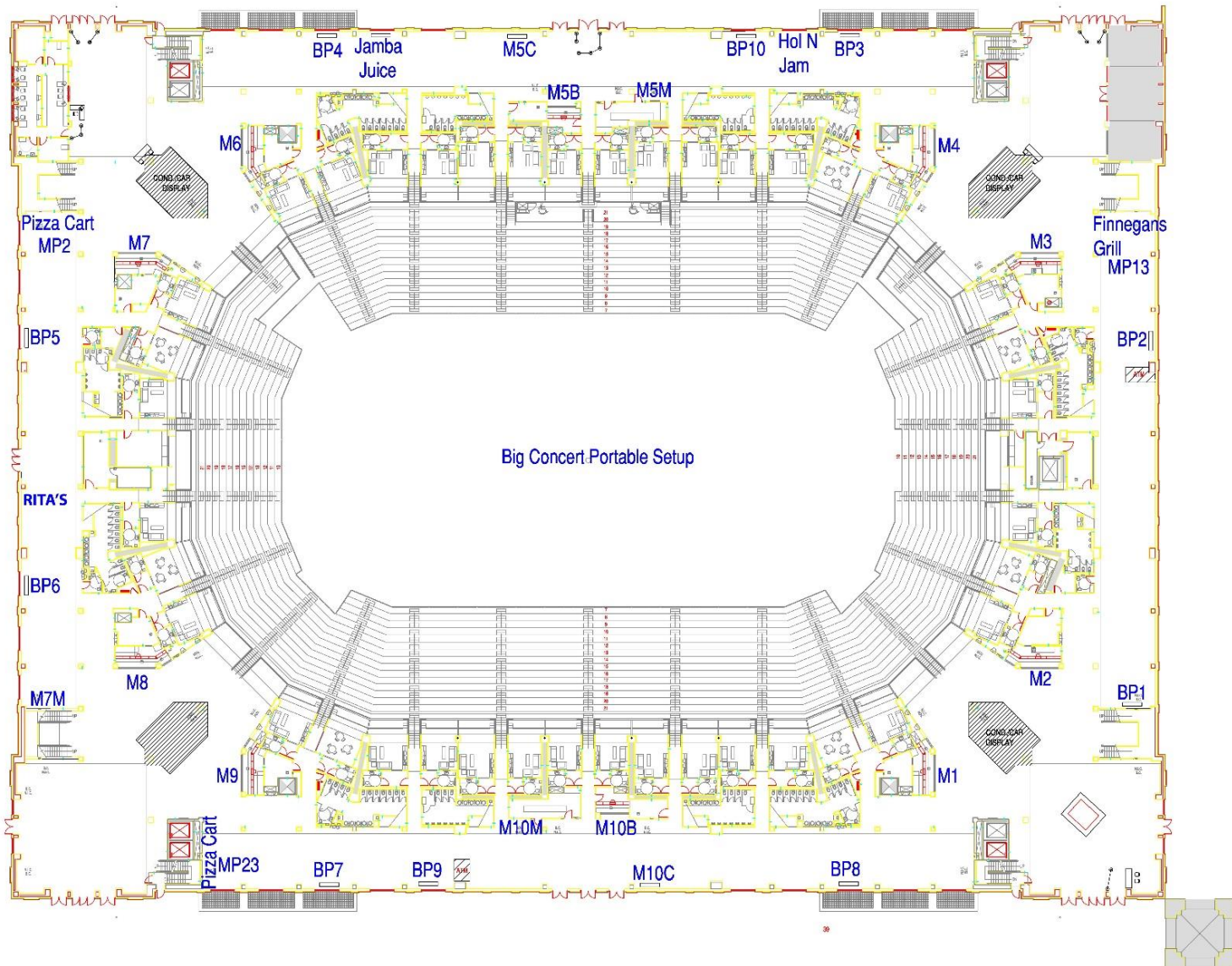

Upper Concourse – Concessions Stand Map

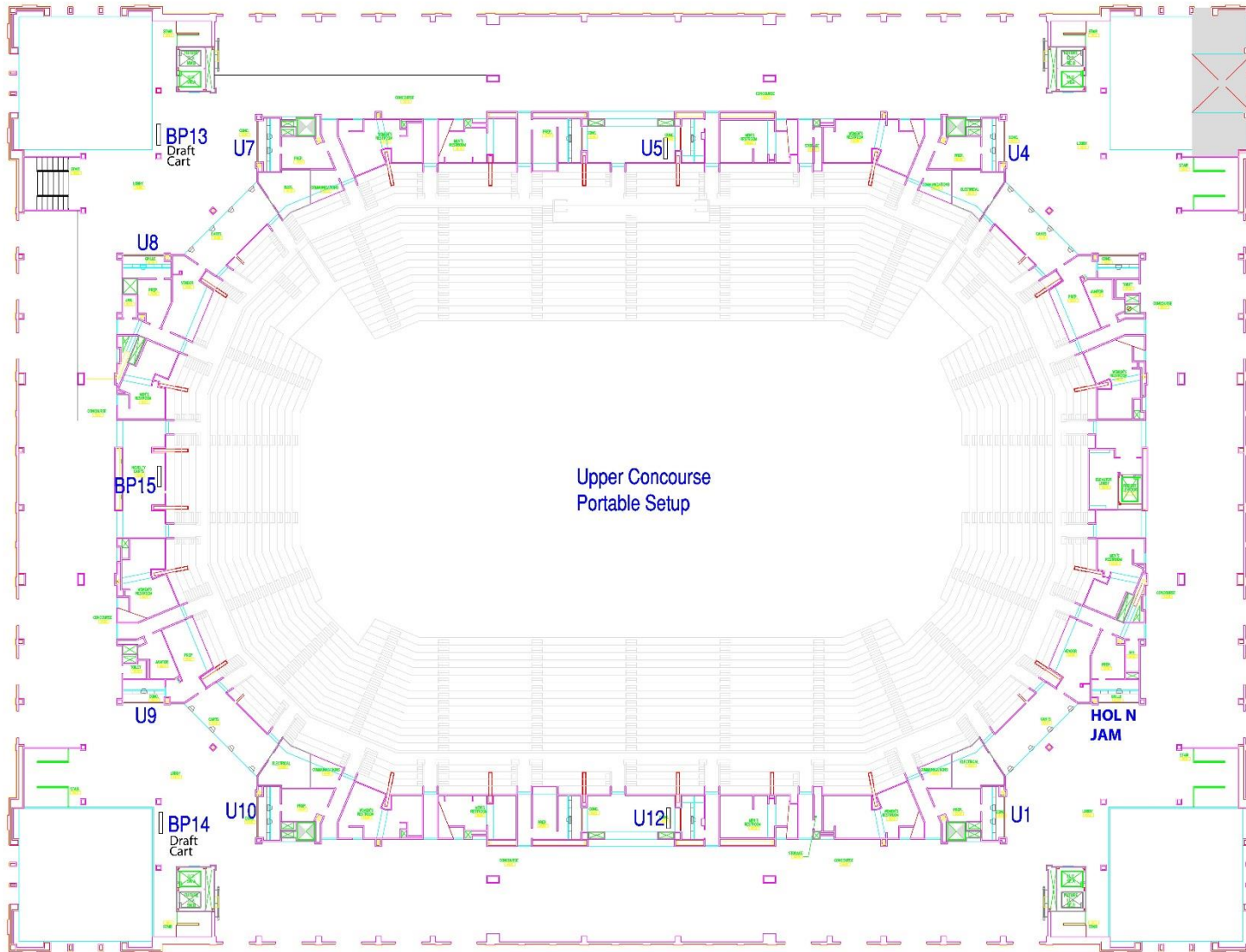

- U1 – (SouthEast Corner)
- U4 – (NorthEast Corner)
- U5 – (North Side - Center)
- U7 – (NorthWest Corner)
- U8 – (NorthWest Corner)
- U9 – (SouthWest Corner)
- U10 – (SouthWest Corner)
- U12 – (South Side - Center)
- BP13 – Beer Portable (NorthWest Corner)
- BP14 – Beer Portable (SouthWest Corner)
- BP15 – Beer booth(Center of West Side)

Event Floor – Concessions Stand Map

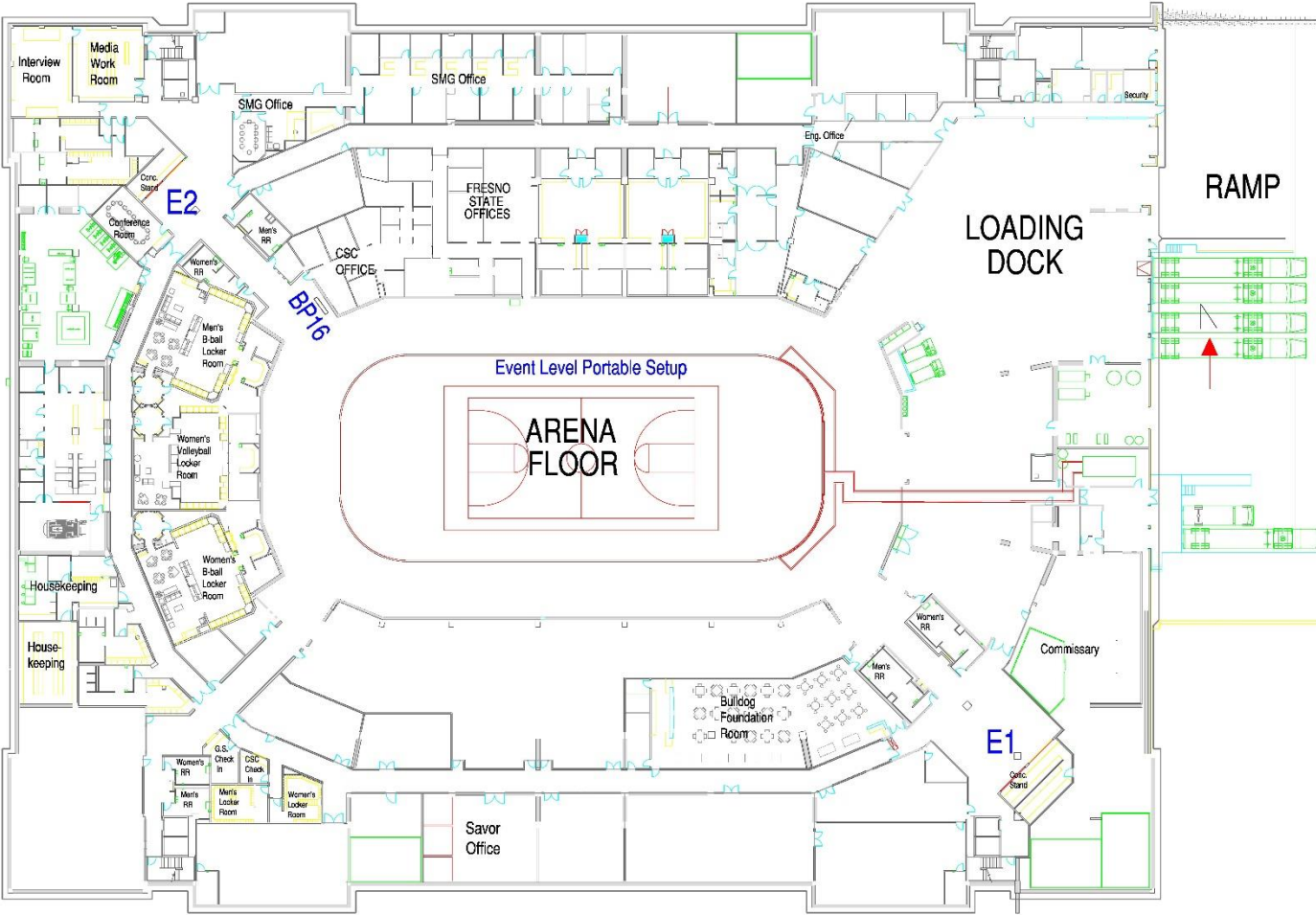

- E1 – Snack Bar (SouthEast Corner)
- E2 – Snack Bar (NorthWest Corner)
- BP16 – Beer Portable (Inside curtain on event floor)